

## Adapter-Plates ISAP-B

Standard dimensions 195 × 195 mm, hole matrix spacing 75 mm

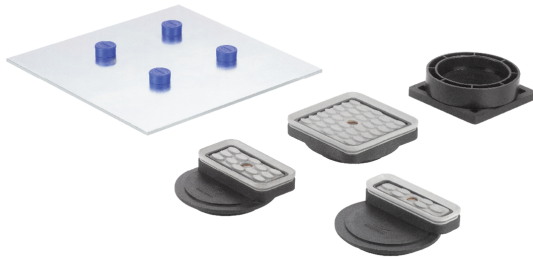

Adapter-Plates ISAP-B

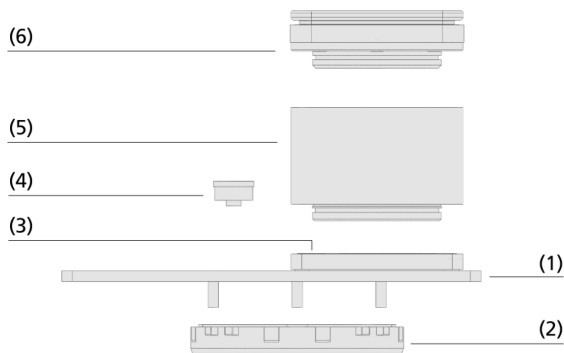

System design Adapter-Plates ISAP-B



Adapter-Plates ISAP-B with Mono-Base and suction cups for clamping wooden components

### Suitability for industry specific applications

#### Application

- Hose-free vacuum clamping system from Schmalz for console tables from Biesse (single-circuit system)
- The Adapter-Plates are positioned directly into the suction cup mounts on the consoles
- The Adapter-Plates can be flexibly equipped with up to four additional Mono-Bases ISMB and suction cups ISCUP
- Particularly suitable for narrow and curved workpieces with small suction surfaces and delicate molds
- The modular concept with connectible spacer rings enables various working heights, which allows for mixed use with suction cups from the original equipment manufacturer
- Damage-free clamping with highest precision and holding force

#### Design

- Adapter-Plate (1) base plate
- Adapter-Ring (2) suitable for the suction cup mounts of the Biesse consoles
- Mono-Base (3) for positioning on the top of the vacuum openings of the Adapter-Plate and suction cup (6) for fixing the workpiece are available as accessories
- Spacer ring (5) for adjusting the height to the machining height of the machine
- Sealing magnet (4)

#### Product highlights

- Ideal for narrow and curved workpieces, as plates and vacuum blocks can be flexibly combined
- Freely positionable suction cups and Mono-Bases allow almost any clamping layout
- Mixed operation with standard vacuum blocks possible for even more flexibility and short set-up times
- Accessories and spare parts can be replaced quickly, easily and cost-effectively without tools

# Adapter-Plates ISAP-B

Standard dimensions 195 × 195 mm, hole matrix spacing 75 mm

## Designation code Adapter-Plates ISAP-B

|        |   |           |
|--------|---|-----------|
| ISAP-B | – | 195x195x5 |
| 1      |   | 2         |

### 1 – Abbreviated designation

| Code   | Type   |
|--------|--|
| ISAP-B | Innospann adapter plate, biesse console system |

### 2 – Dimensions

| Code      | LxWxHeight in mm |
|-----------|------------------|
| 195x195x5 | 195x195x5        |

The Adapter-Plate ISAP-B is delivered assembled. The product consists of:

- Base plate made of steel
- Sealing magnet for closing the vacuum openings
- Adapter ring made of plastic

Available spare parts: sealing magnet

Available accessories: Mono-Base, spacer ring, suction cups

## Ordering data Adapter-Plates ISAP-B

| Type             | Part no.       |
|------------------|----------------|
| ISAP-B 195x195x5 | 10.01.14.00109 |



## Ordering data Spare parts Adapter-Plates ISAP-B

| Type                               | Part no.   |
|------------------------------------|--|
| Sealing magnet   ISMST 19-7 4ISMST | 10.01.14.00847  |

## Ordering data Accessories Adapter-Plates ISAP-B

| Type                     | Part no.   |
|--------------------------|--|
| Mono-Base   ISMB 80x80x8 | 10.01.15.00188  |

| Type                                  | Part no.       |
|---------------------------------------|----------------|
| Spacer ring, Innospann   ISZR-V 80x19 | 10.01.15.00388 |
| Spacer ring, Innospann   ISZR-V 80x45 | 10.01.15.00054 |

| Type                       | Part no.   |
|----------------------------|--|
| Cup   ISCUP Cup 1 80x80x16 | 10.01.15.00209  |
| Cup   ISCUP Cup 2 80x40x16 | 10.01.15.00210  |
| Cup   ISCUP Cup 3 80x28x16 | 10.01.15.00211  |

## Adapter-Plates ISAP-B

Standard dimensions 195 × 195 mm, hole matrix spacing 75 mm

### Design data Adapter-Plates ISAP-B

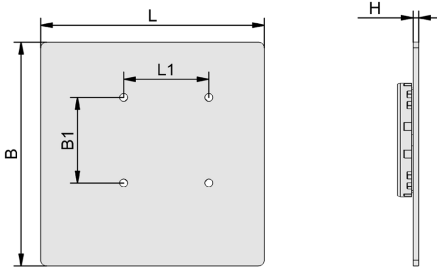

ISAP-B

### Design data Adapter-Plates ISAP-B

| Type             | B [mm] | B1 [mm] | H [mm] | L [mm] | L1 [mm] |
|------------------|--------|---------|--------|--------|---------|
| ISAP-B 195x195x5 | 195    | 75      | 5      | 195    | 75      |